

LAND DESCRIPTION	ON	CERTIFICATE OF TITLE	FIELD BOOK	TOTAL AREA
SUBDIVISION OF PERTH SUBURBAN LOT 479 AND PT. LOT 4 OF PERTH LOTS 751 & 858, SWAN LOCATIONS 11526, 11923 & 11924	PLAN 23126	VOLUME 2154	FOLIO 833	2.2035 ha
	DIAGRAM CS P2020	2127	731	@ RL 26.5
	INDEX BG 34 (2), 11, 25, 11, 26			2.2003 ha.
	PUBLIC BG 34 (2), 11, 25, 11, 26			@ Ground Level

TENURE ABOVE AND BELOW
THREE DIMENSIONAL LOTS

LOCALITY - SUBIACO
LOCAL AUTHORITY - CITY OF SUBIACO

- A Station Street above Swan Location 13155 on CS Plan 20047
- B Lot 315 above Station Street
- C Lot 315 above Station Street above Swan Location 13155
- D Lot 315 above Swan Location 13155
- E Subiaco Square Road above Swan Location 13156 on CS Plan 20047
- F Lot 315 above Lot 341 on Diagram 96102
- G Subiaco Square Road above Lot 341 on Diagram 96102
- H Lot 319 above Swan Location 13157 on CS Plan 20047
- I Brigid Road above Swan Location 13157 on CS Plan 20047

LIMITED IN DEPTH TO 12.19 METRES BELOW GROUND LEVEL PORTIONS OF THE WITHIN LAND ARE FURTHER RESTRICTED IN DEPTH TO THE HEIGHT DATUMS SHOWN HEREON, AND AS CREATED ON DIAGRAM 96102 AND CS PLANS 20047 & 20048

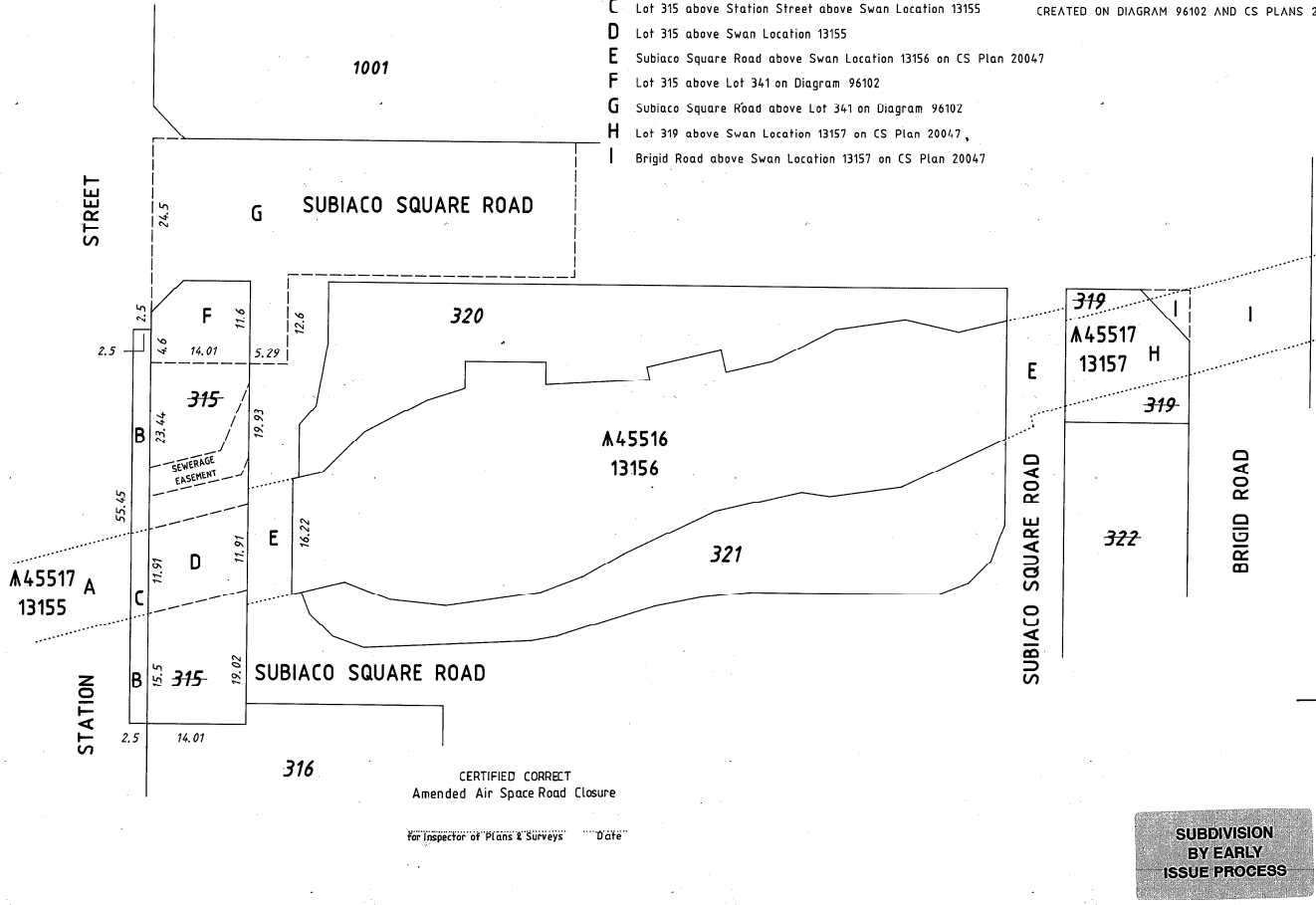

CERTIFIED CORRECT
Amended Air Space Road Closure

for Inspector of Plans & Surveys Date

SUBDIVISION
BY EARLY
ISSUE PROCESS

SWAN LOCATION 13515
(ROAD CLOSURE - AIR SPACE ONLY)
DOCUMENT H369621
C. L. T. 3033 - 623
CORR 1423 / 1999

NOT TO SCALE
CROSS SECTION
VIEW

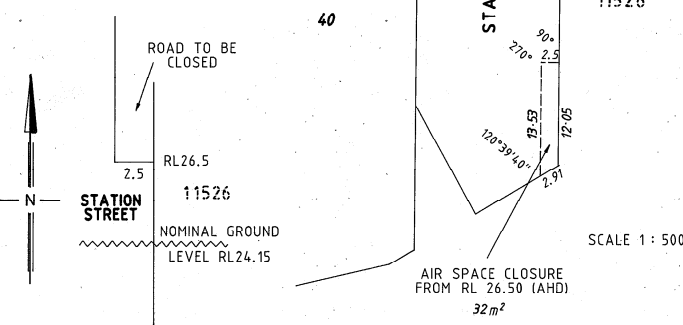

AIR SPACE CLOSURE
FROM RL 26.50 (AHD)
32m²

SCALE 1 : 500

The polygons (E), (H) and (I) are limited in depth to the reduced levels shown on the schedule for the respective points. Locations 13156 & 13157 are below the surface formed.

SUBIACO SQUARE ROAD

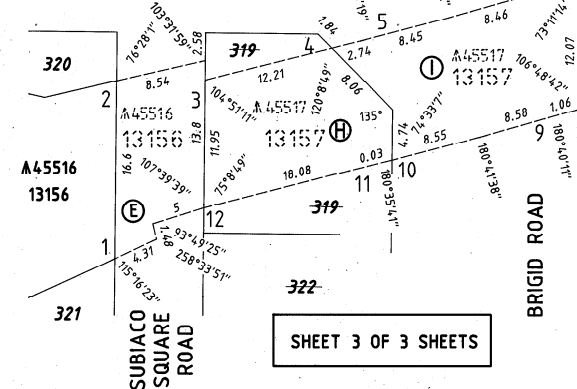

SHEET 3 OF 3 SHEETS

POINT	R.L.
1	23.82
2	23.82
3	23.86
4	23.95
5	24.36
6	24.84
7	24.92
8	24.86
9	24.81
10	24.36
11	24.36
12	23.86

Maps McMULLEN NOLAN AND PARTNERS SURVEYORS PTY LTD

Unit 9, 28 Richardson Street, PO Box 117, South Perth WA 6961 Telephone: (08) 9474 1099 Facsimile: (08) 9474 1098

SURVEYOR'S CERTIFICATE - Reg 54

SCOTT JOHN ANDERSON

I, SCOTT JOHN ANDERSON, hereby certify that:
this plan of survey is a correct and accurate representation of the survey and/or calculations from measurements recorded in the fieldbook lodged for the purposes of this plan and that it complies with the relevant written law(s) in relation to which it is lodged.

Licensed Surveyor Date

SURVEYOR'S CERTIFICATE - Compiled

I, SCOTT JOHN ANDERSON, hereby certify that this compiled plan:
(a) is a correct and accurate representation of the survey(s) of the subject land; and
(b) is in accordance with the relevant law in relation to which it is lodged.

Licensed Surveyor Date

APPROVED BY Hon. MINISTER FOR PLANNING

SU9

FILE: *gouind*
Hon. MINISTER FOR PLANNING
DATE: 22-12-99

EARLY ISSUE YES
LODGED

DATE: 6.10.99
FEE PAID: 2319
ASSESSMENT No.:

TYPE OF VALIDATION

FULL AUDIT
LEGAL COMPONENT: *A. Scullion*
DOCKET: 99034
PERY/DIAGRAM CERTIFIED CORRECT: *A. Scullion*
F.S.C. No. 405-1999

NOT TO SCALE

IN ORDER FOR DEALINGS

SUBJECT TO AMMAGAMATION ORDER

SEC. 225(S) OF LOCAL GOVT. ACT, 582

20 A 27A 29 (3) OF T.P.A.D. ACT 582

FOR INSPECTOR OF PLANS & SURVEYS DATE: 21-2-2000

APPROVED: *A. Scullion* DATE: 22-2-00

FOR INSPECTOR OF PLANS & SURVEYS



OFFICE OF TITLES
PLAN

EXAMPLE 39