

**STRATA PLAN
EXAMPLE 53.1**

SHEET 1 OF 2 SHEETS

PLAN OF

LOT 757 ON DP 50057

CERT. OF TITLE
VOLUME: 2621 FOLIO: 964
LOCAL GOVERNMENT
CITY OF SWAN
INDEX PLAN
SEE SMART PLAN
FIELD BOOK

SCALE 1:300 AT A3

NAME OF SCHEME
10 - 16 DULEGAL WAY
AVELEY.

ADDRESS OF PARCEL
10 DULEGAL WAY
AVELEY, 6069.

MANAGEMENT STATEMENT YES NO

LODGED DATE	CERTIFIED CORRECT
FEE PAID	COR. FILE
ASSESS No.	IN ORDER FOR DEALINGS SUBJECT TO

REGISTERED

APPLICATION
DATE REGISTRAR OF TITLES SEAL

WESTERN AUSTRALIAN PLANNING COMMISSION
W.A.P.C. REF = BS2/2009
City of Swan FORM 26
STRATA TITLES ACT 1985
Sections 25(1), 25(4)

It is hereby certified that the approval of the Western Australian Planning Commission has been granted pursuant to section 25(1) of the Strata Titles Act 1985 to -

The Strata Plan/Plan of Re-Subdivision/Plan of Consolidation submitted on and relating to the property described herein (delete as appropriate)

FOR CHAIRMAN, WESTERN AUSTRALIAN PLANNING COMMISSION DATE



Western Australian Land Information Authority

CORICH PASS

AVENUE
BROOK
HENLEY

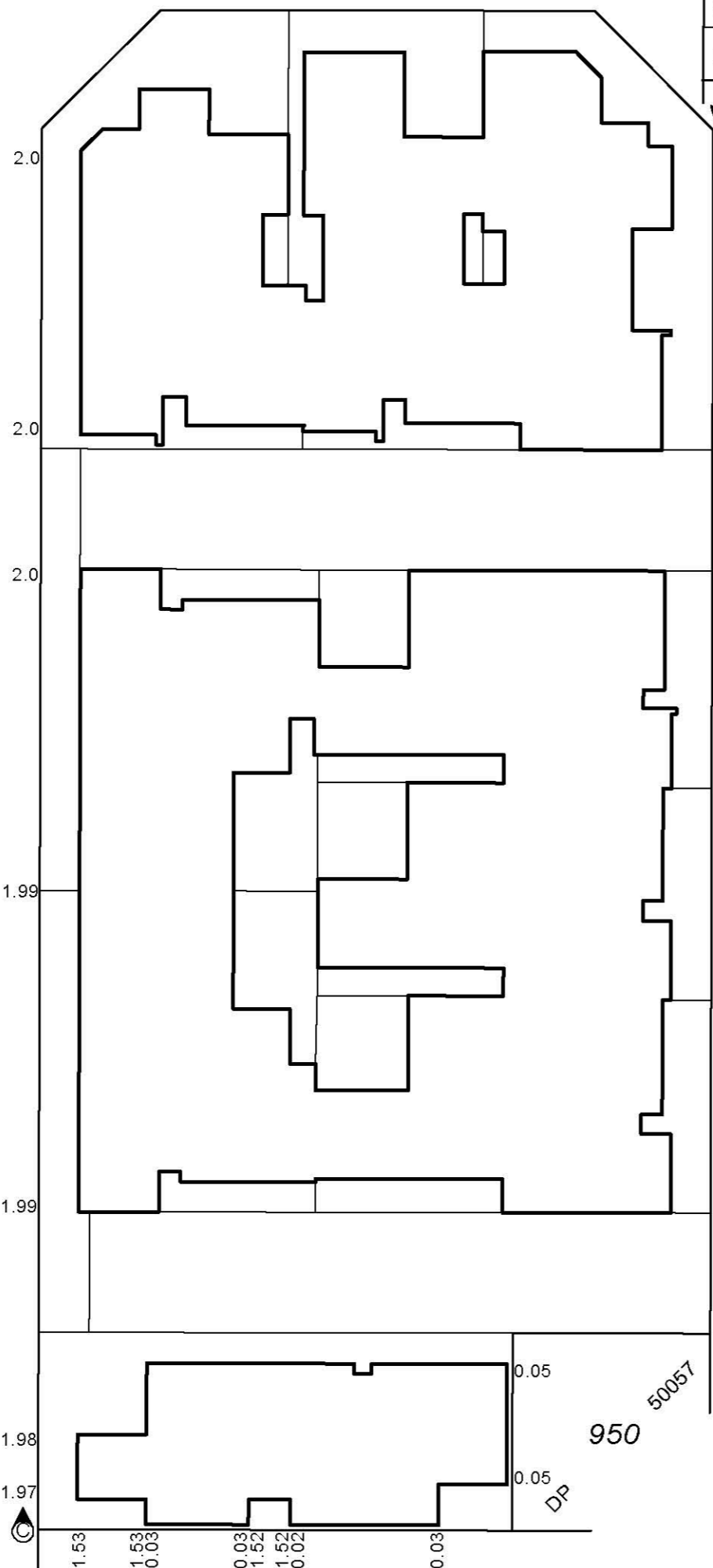

INTERESTS AND NOTIFICATIONS

SUBJECT	PURPOSE	STATUTORY REFERENCE	ORIGIN	LAND BURDENED	BENEFIT TO	COMMENTS
ⓑ ⓐ	Restrictive Covenant	SEC 129BA OF THE T.L.A.	Doc. J741276	All Lots & Common Property	City of Swan	Restriction of Access

VER	AMENDMENT	AUTHORISED BY	DATE

WAY

DULEGAL

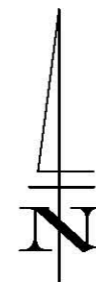

LOCATION PLAN
(SCALE 1:300) AT A3

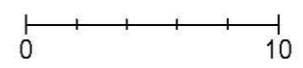

SURVEYOR'S CERTIFICATE - Reg 54
.....
hereby certify that this plan is accurate and is a correct representation of the -
(a) survey; and
(b) calculations from measurements,
undertaken for the purposes of this plan and that it complies with the relevant written law(s) in relation to which it is lodged.
.....
LICENSED SURVEYOR DATE

STRATA PLAN

FORM 26

City of Swan

WAPC Ref. BS2/2009

STRATA PLAN NO: 58455

Strata Titles Act 1985

Sections 25(1), 25(4)

CERTIFICATE OF GRANT OF APPROVAL BY WESTERN AUSTRALIAN PLANNING COMMISSION TO STRATA PLAN

It is hereby certified that the approval of the Western Australian Planning Commission has been granted pursuant to section 25(1) of the *Strata Titles Act 1985* to -

- * (i) the *Strata Plan/~~plan of re-subdivision/plan of consolidation~~ submitted on 11 August 2009 and relating to the property described below;
- * (ii) ~~the sketch submitted on _____ of the proposed *subdivision of the property described below into lots on a Strata Plan/re-subdivision / consolidation of the lots on the Strata Plan specified below, subject to the following conditions -~~

Property Description: Lot (or Strata Plan) No: 757

Location: Corich Pass, Aveley

Locality: Aveley

Local Government: **City of Swan**

Lodged by: Cottage & Engineering Surveys
PO Box 7100
SHENTON PARK WA 6008

Date: 11-Aug-2009

Michael James Foley

Chief Executive Officer
For Chairman, Western Australian
Planning Commission

15/9/09
Date:

(*To be deleted as appropriate)

Delegated under Sec.16 P & D Act 2005