

SURVEY STRATA PLAN EXAMPLE 39.2

SHEET 1 OF 1 SHEETS

MANAGEMENT STATEMENT YES NO

Lodged 9.2.2004 \$215 408862

Examined 3.3.2004 #

Registered 16.3.2004 I820750

RG Roberts

REGISTRAR OF TITLES

WESTERN AUSTRALIAN PLANNING COMMISSION
W.A.P.C REF 649-03
Certificate of Approval of W.A.P.C.
under Section 25B(2)
of the Strata Titles Act 1985.

Alayne Gunn 3-FEB-2004
FOR CHAIRMAN DATE

PLAN OF
LOT 106 ON DP 31394.

CERT. OF TITLE
VOL. 1263 FOL. 723

LOCAL GOVERNMENT
CITY OF SWAN

INDEX PLAN
BG34(2)22.32

FIELD BOOK NUMBER
90874

NAME OF SCHEME
129 MORRISON ROAD
MIDLAND

ADDRESS OF PARCEL
129 MORRISON ROAD
MIDLAND, 6056.

LICENSED SURVEYOR

Frank Mastaglia
FRANK MASTAGLIA

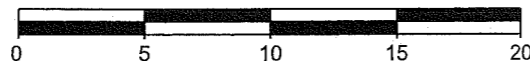
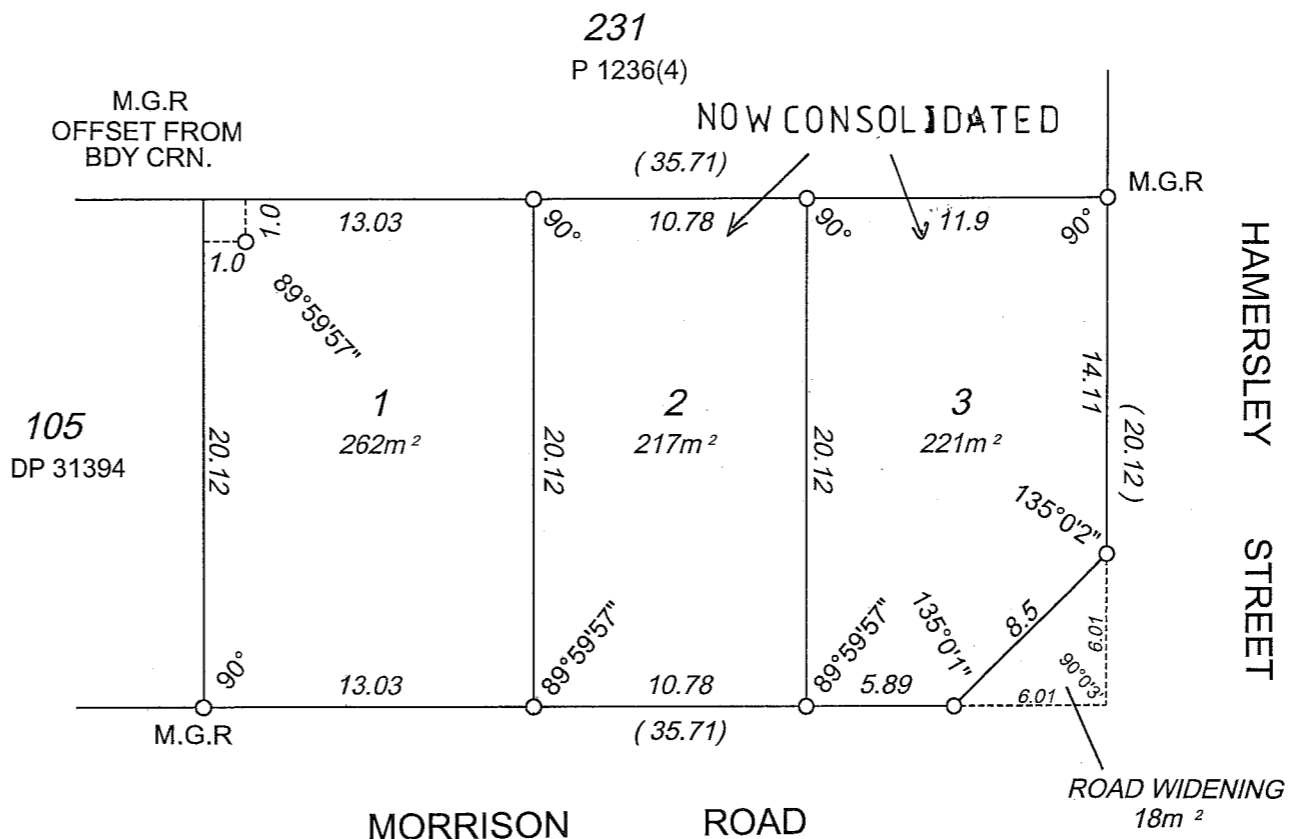
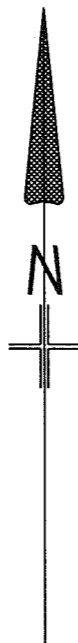

1:300

INTERESTS AND NOTIFICATIONS

SUBJECT	PURPOSE	STATUTORY REFERENCE	ORIGIN	LAND BURDENED	BENEFIT TO	COMMENTS
	MEMORIAL	SECTION 67B OF THE WATER AGENCIES (POWERS) ACT 1984.	THIS PLAN	STRATA LOT 2 & 3	WATER CORPORATION	

AS AUTOMATED SURVEYS PTY LTD AS128935
LICENSED SURVEYORS AND DEVELOPMENT CONSULTANTS
3 Ord Street, West Perth, W.A. 6005. P.O.Box 1648 West Perth 6872 Telephone (08) 9214 1777 Facsimile (08) 9214 1778

SURVEY / STRATA PLAN NO.



STRATA PLAN

FORM 3

STRATA/SURVEY-STRATA PLAN NO. 44120

Schedule of Unit Entitlement		Office Use Only		Schedule of Unit Entitlement		Office Use Only	
		Current Cs of Title				Current Cs of Title	
Lot No.	Unit Entitlement	Vol.	Fol.	Lot No.	Unit Entitlement	Vol.	Fol.
1	36	2559	498				
2	NOW CONSOLIDATED 32	2559	499	SEE			
3	NOW CONSOLIDATED 32	2559	500	J316465			
4	64	2595 - 580					
				Aggregate	100		

DESCRIPTION OF PARCEL AND BUILDING/PARCEL

Lot 106, on Deposited Plan 31394, on certificate of title Volume 1263 Folio 723, and having a street address of 129 Morrison Road, Midland.

CERTIFICATE OF LICENSED VALUER
STRATA/SURVEY STRATA

I, **Kevin Sydney Johnson**, being a Licensed Valuer licensed under the *Land Valuers Licensing Act 1978* certify that the unit entitlement of each lot (in this certificate, excluding any common property lots), as stated in the schedule bears in relation to the aggregate unit entitlement of all lots delineated on the plan a proportion not greater than 5 per cent more or 5 per cent less than the proportion that the value (as that term is defined in section 14 (2a) of the *Strata Titles Act 1985*) of that lot bears to the aggregate value of all the lots delineated on the plan.

6th. February 2004
Date

Signed

FORM 6

Strata Titles Act 1985

Sections 5B (1), 8A, 22 (2)

SURVEY-STRATA PLAN No. 44120

DESCRIPTION OF PARCEL

Lot 106, on Deposited Plan 31394 on C/T Vol. 1263 Fol. 723 and having a street address of 129 Morrison Road, Midland.

CERTIFICATE OF LICENSED SURVEYOR

Frank Mastaglia

I,....., being a licensed surveyor registered under the Licensed Surveyors Act 1909 certify that in respect of the survey-strata plan which relates to the parcel described above (in this certificate called "the plan"):-

- (a) the plan is a correct and accurate representation of the survey carried out *by me personally/or under my own personal supervision, inspection and field check, and recorded in Field Books kept, and if required lodged, for the purposes of this plan;
(b) the measurements are in strict accordance with the Licensed Surveyors (Guidance of Surveyors) Regulations 1961 and in particular regulations 23 and 34 of those regulations;
(c) this survey and plan are in strict accordance with the requirements of the Licensed Surveyors (Guidance of Surveyors) Regulations 1961 and the relevant law in relation to which it is lodged; and

* (d) if the plan is a plan of re-subdivision, it complies with Schedule 1 by-law(s) No(s)..... on Survey-Strata Plan No..... registered in respect of (name of scheme)..... or sufficiently complies with that/those by-law(s) in a way that is allowed by regulation 36 of Strata Titles General Regulations 1996.

6.2.2004
Date

[Signature]
Licensed Surveyor

* Delete if inapplicable

