

**SURVEY-STRATA PLAN
EXAMPLE 16**

SHEET 1 OF 1 SHEETS

PLAN OF	
CERTIFICATE OF TITLE	
LOCAL GOVERNMENT	
FIELD RECORD	
NAME OF SCHEME	
ADDRESS OF PARCEL	
MANAGEMENT STATEMENT	YES NO
SURVEYOR'S CERTIFICATE - REG 54	
I, hereby certify that this plan is accurate and is a correct representation of the -	
(a) *survey; and/or	
(b) *calculations from measurements recorded in the field records,	
[* delete if inapplicable]	
undertaken for the purposes of this plan and that it complies with the relevant written law(s) in relation to which it is lodged.	
LICENSED SURVEYOR	DATE
LOGGED	
DATE	FEE PAID ASSESS No.
EXAMINED	
DATE	
WESTERN AUSTRALIAN PLANNING COMMISSION	
W.A.P.C. REF:	
Certificate of Approval of W.A.P.C. under Section 25B(2) of <i>Strata Titles Act 1985</i>	
Delegated under S.16 P&D Act 2005	DATE
PLAN APPROVED	
INSPECTOR OF PLANS AND SURVEYS	DATE
(S. 18 Licensed Surveyors Act 1909)	
IN ORDER FOR DEALINGS	
SUBJECT TO	
FOR REGISTRAR OF TITLES	DATE
REGISTERED	
APPLICATION	
DATE	REGISTRAR OF TITLES SEAL

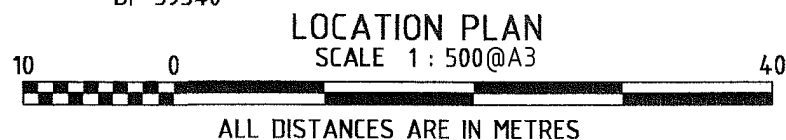
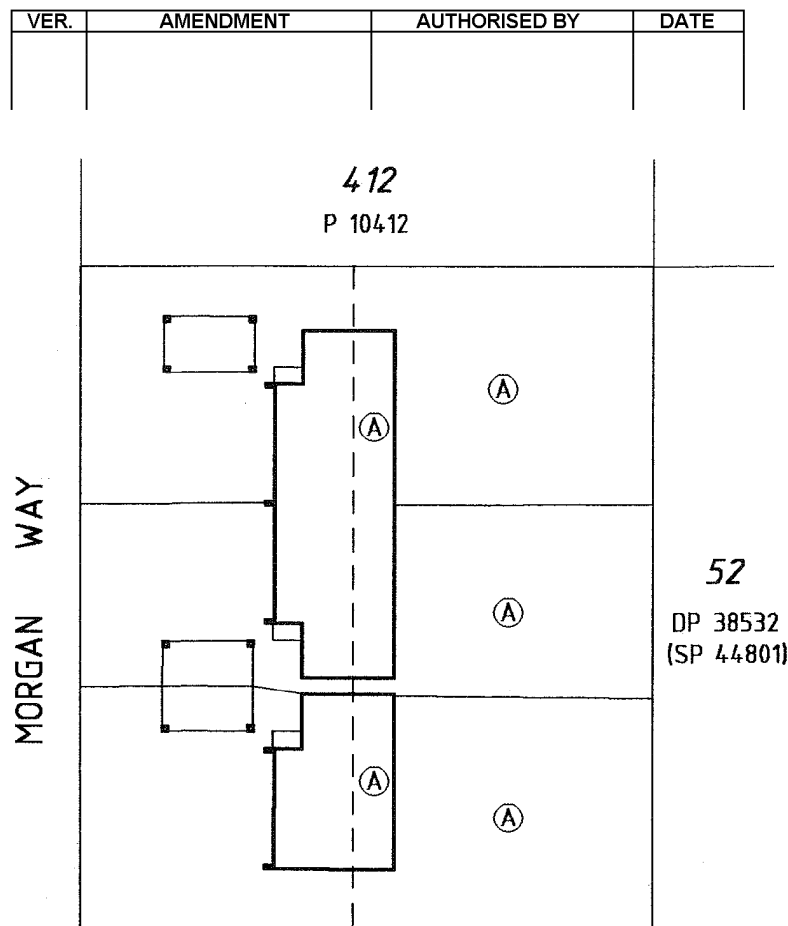

LOCATION PLAN
SCALE 1 : 500@A3

THE BOUNDARIES OF THE LOTS OR PARTS OF THE LOTS WHICH ARE BUILDINGS SHOWN ON THE STRATA PLAN ARE THE EXTERNAL SURFACES OF THOSE BUILDINGS AS PROVIDED BY SECTION 3AB OF THE *STRATA TITLES ACT 1985*.

WHERE 2 LOTS HAVE A COMMON OR PARTY WALL OR HAVE BUILDINGS ON THEM WHICH ARE JOINED, THE CENTRE PLANE OF THAT WALL, OR THE PLANE AT WHICH THEY ARE JOINED, IS THE BOUNDARY.

THE STRATUM OF PART LOTS EXTERNAL TO THE BUILDING EXTENDS FROM 5 METRES BELOW TO 10 METRES ABOVE THE UPPER SURFACE OF THE LOWEST FLOOR LEVEL OF THE BUILDING ON EACH RESPECTIVE LOT, EXCEPT WHERE COVERED.

PILLARS FORM PART OF THE LOTS AT CORNERS OF CARPORTS. CP DENOTES CARPORT.

ALL DIMENSIONS FROM BUILDINGS ARE FROM EXTERNAL FACE OF WALLS UNLESS OTHERWISE STATED.

GROUND FLOOR PLAN

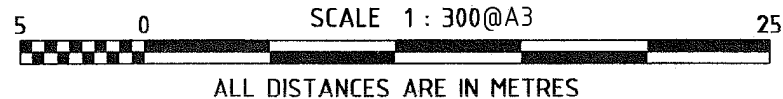
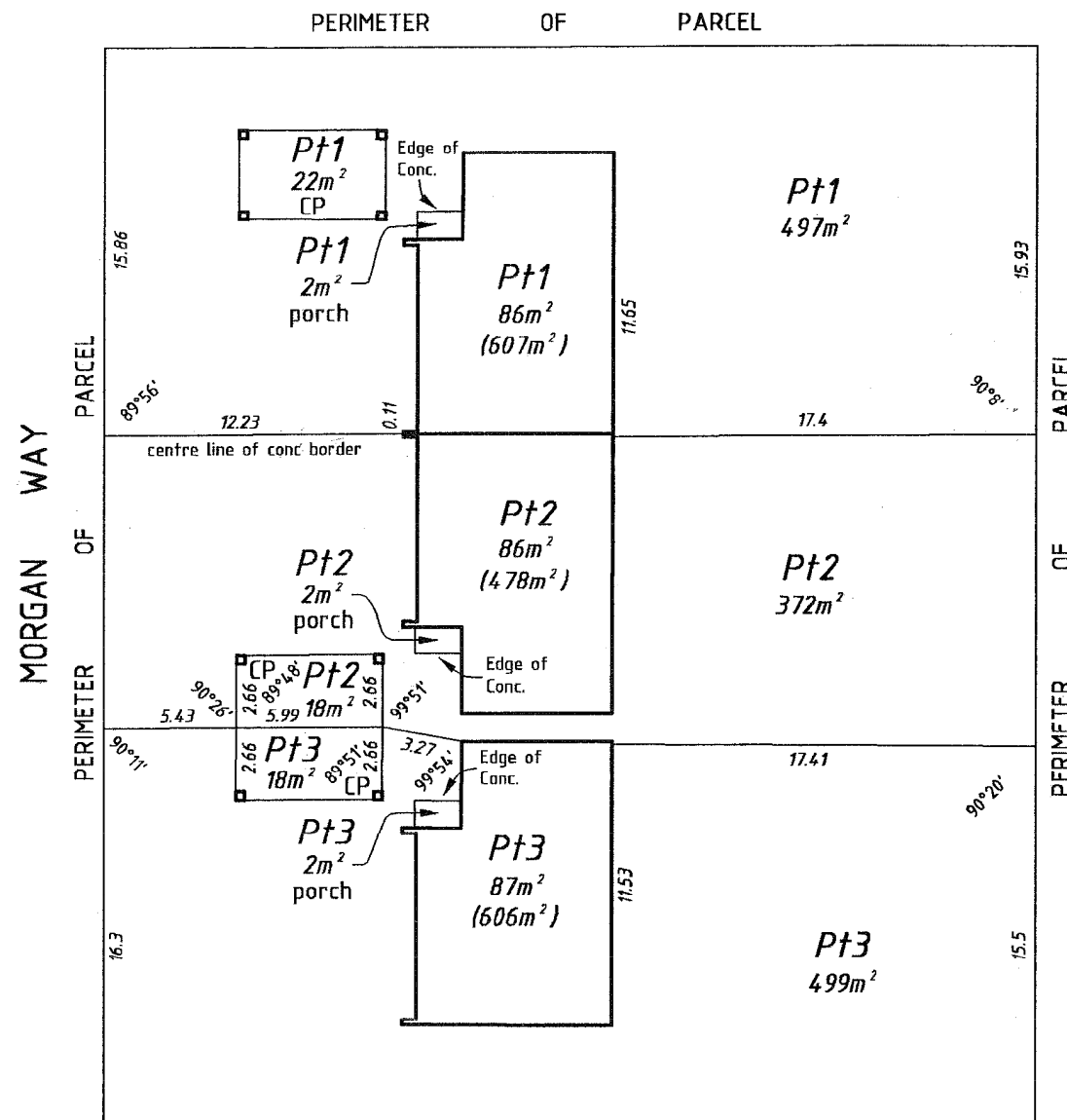

PERIMETER OF PARCEL

SCALE 1 : 300@A3

INTERESTS AND NOTIFICATIONS

SUBJECT	PURPOSE	STATUTORY REFERENCE	ORIGIN	LAND BURDENED/ SERVIENT LOT	BENEFIT TO/ DOMINANT LOT	COMMENTS
(A)	MINERAL RESERVATION	SEC 15 OF THE PUBLIC WORKS ACT		ALL LOTS AND COMMON PROPERTY		

